

PARTS LIST

Index	Part No.	Description	Qty.
1	34-340231	Frame Assembly, Left	1
2	34-340232	Frame Assembly, Right	1
3	20-231010	Plastic Engine Deflectors	2
4	37-370950	Outside Plate, Chrome	4
BAG 850			
5	42-480000	Nut, 1/4-20 Hex Cap	10
6	49-490521	Washer Flat	4
8	50-504800	CS, Hex 1/4-20 x 8	2
9	49-492780	Washer Belleville 1/4 ID	2
10	49-490523	Washer, Flat Nylon	12
11	37-371237	Bracket "A" Eng. Deflector	2
12	37-371238	Bracket "B" Eng. Deflector	2
13	50-530500	MS, Binder 1/4-20 Nylon	8
16	44-448805	Bumper, Mushroom	2

MAINTENANCE

To clean the plastic, wash with a clean soft cloth, plenty of warm water and, if necessary, a non-abrasive soap such as dishwashing liquid. Flannel or soft chamois make good cleaning cloths. Paint, glue residue or grease removal: Moisten cotton with Naphtha or Turpentine followed by a wash as above.

NOTE: Right and Left side of Motorcycle is determined while sitting on the bike.

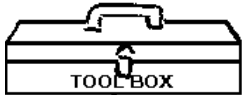
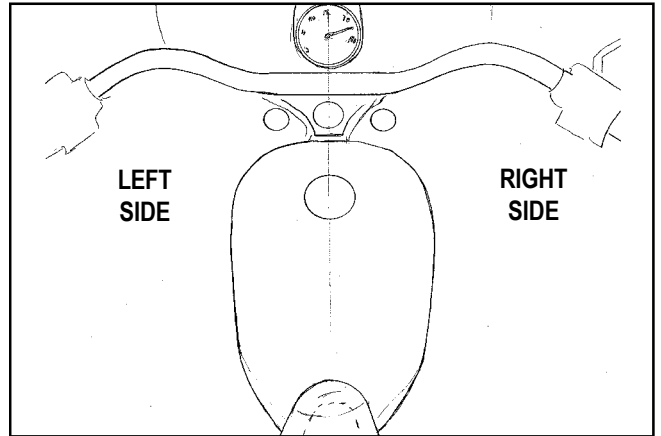

Wrench, 14mm
Two Wrenches, 7\16 Screwdriver, Flat

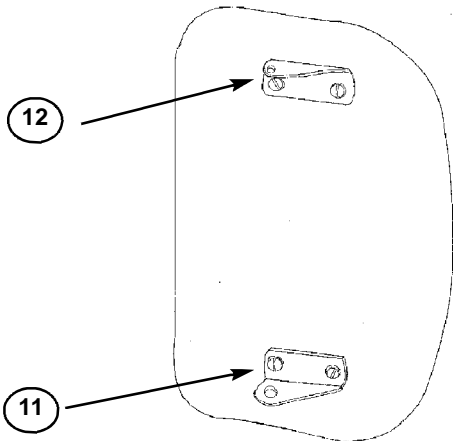
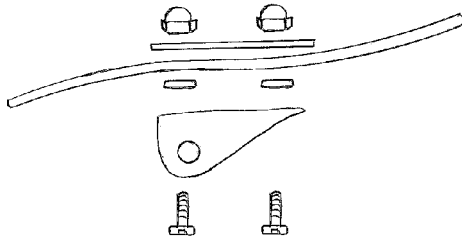
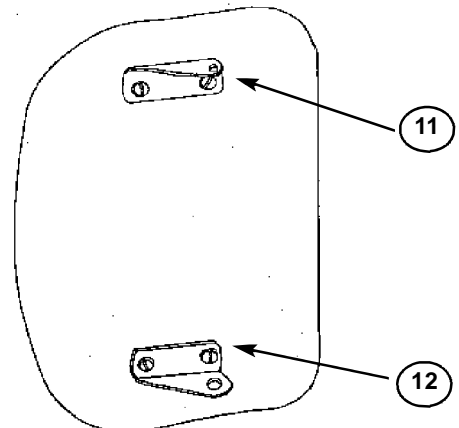
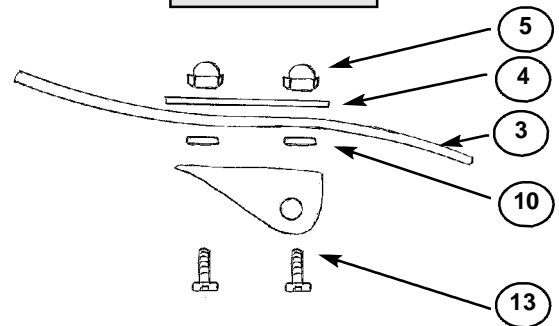
PREASSEMBLE PARTS TO PLASTIC OF ENGINE DEFLECTOR AS INDICATED
LEFT SIDE

RIGHT SIDE

INSTALL PLASTIC ASSEMBLY TO FRAME

LEFT

NOTE: Compress
belleville washers (9),
do not flatten (5ft lbs.)
(7Nm) Adjust after
riding if necessary.

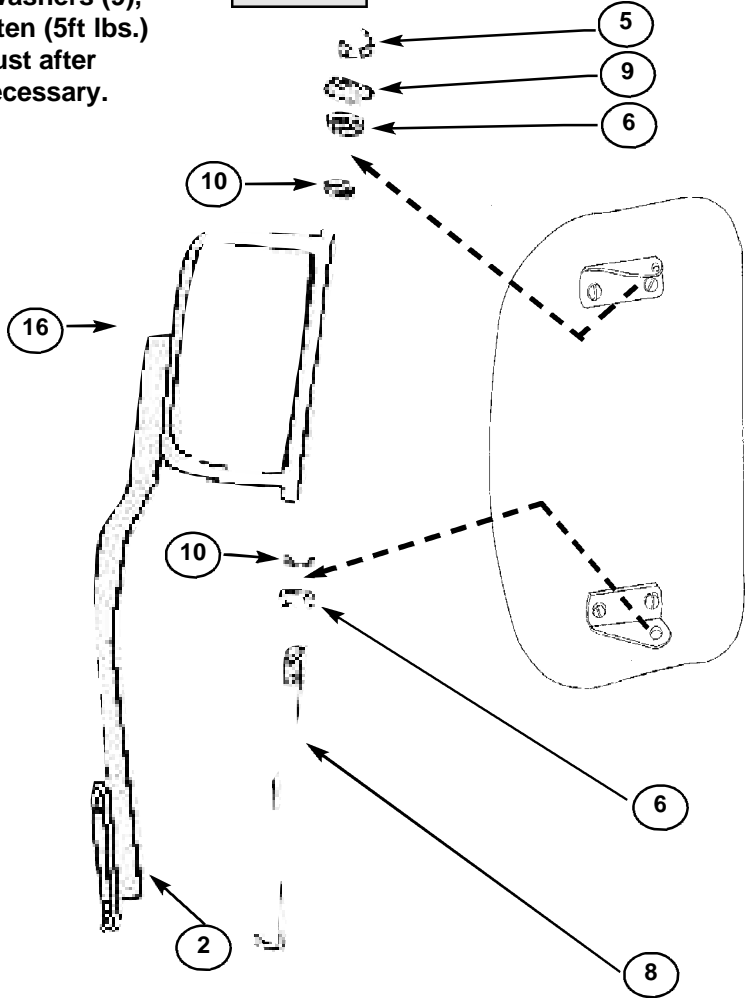
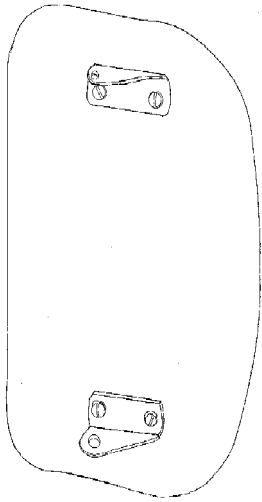
RIGHT



When installing the Right Side Engine Deflector Installation: Remove the two nuts that hold the Rear Brake Light Switch. Install engine Deflector under plate. Secure with original nuts. Note: When mounting Frame to motorcycle, keep the frame rod *Vertical* on both the left and right side. **IMPORTANT:** Tighten frames installed with the Motor mount bolts to 25 ft. lbs (35 Nm).

LEFT

Under
side of
floor
board

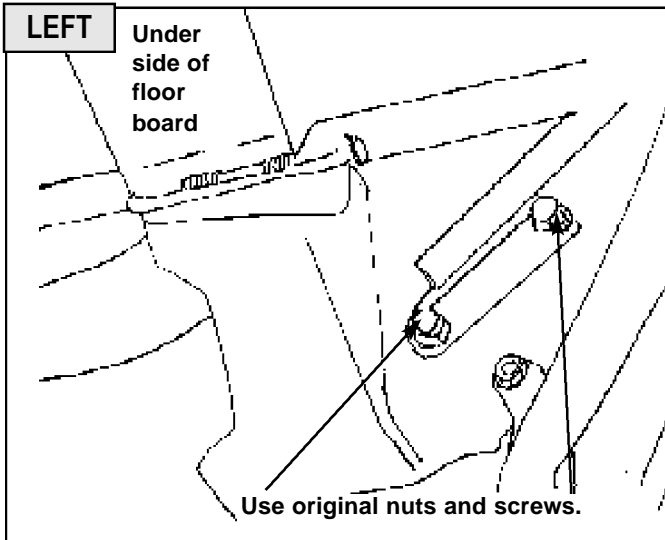

RIGHT

Under
side of
floor
board

